

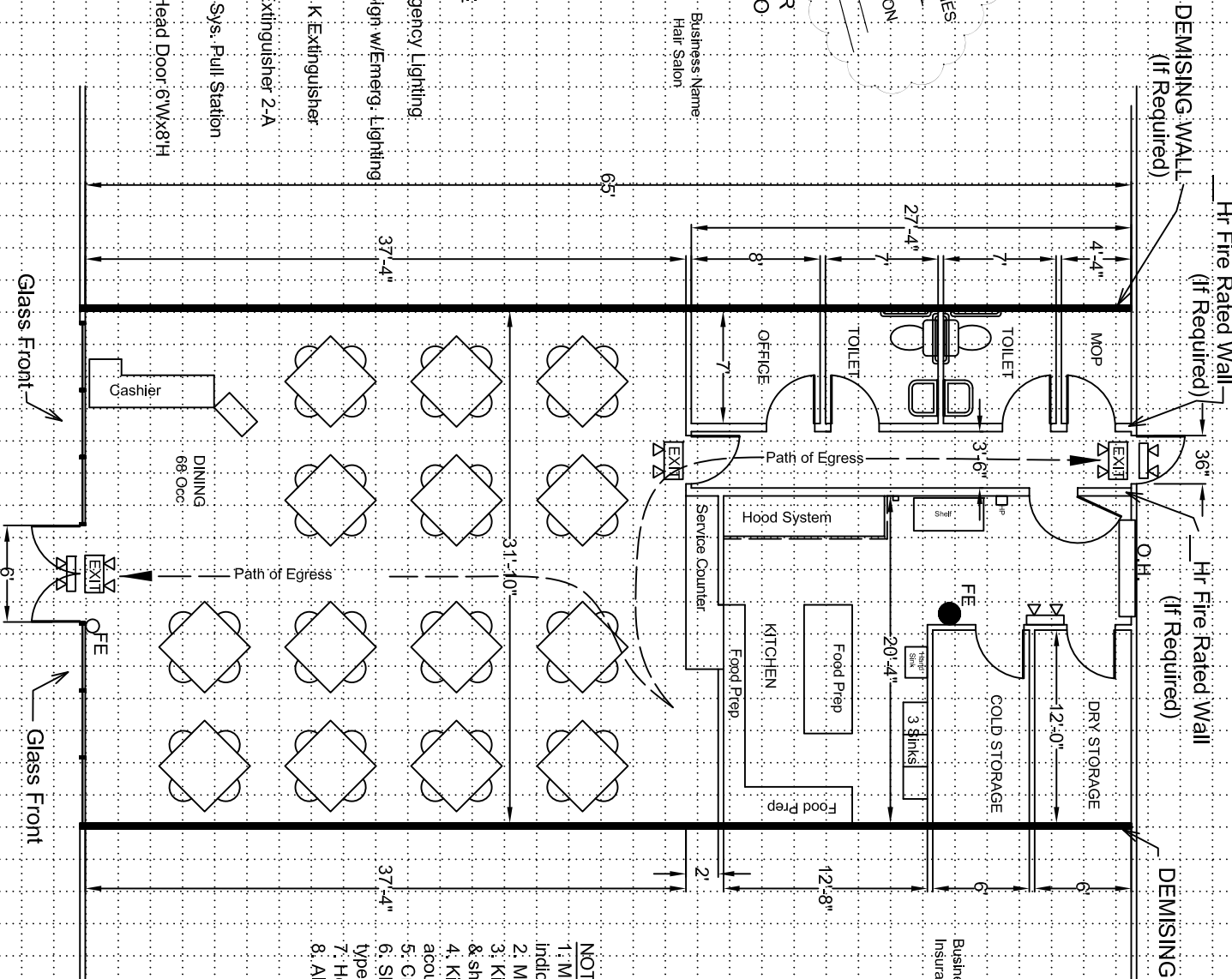

HARRIS COUNTY P.H.E.S.
 FINAL APPROVAL
 SUBJECT TO
 FIELD INSPECTION
 DATE: _____
 BY: _____

REQUIRED PRIOR
 TO SUBMITTAL TO
 THIS OFFICE

- LEGEND:**
- Emergency Lighting
 - EXIT Exit Sign w/Emerg. Lighting
 - FE Class K Extinguisher
 - FE Fire Extinguisher 2-A
 - Hood Sys. Pull Station
 - O.H. Overhead Door 6'Wx8'H



- NOTES:**
- 1: Main entrance door shall have lock indicators
 - 2: Molded plastic chair rail in Dining Area
 - 3: Kitchen Walls are FRP Panels upto 6' Ht & sheetrock above
 - 4: Kitchen ceiling is washable vinyl coated acoustical tile and metal grid
 - 5: Crown molding in Dining Area is foam
 - 6: Shelving & Racks in Dry Storage - Height type layout
 - 7: Hood System is Type One
 - 8: All Doors are more than 32" Wide

Sample Only - DO NOT REPLICATE

LSBO <small>LEASE SPACE BUILD OUT</small> PAGE # _____ OF _____	Scale: = 1'	PROJECT NAME: <u>Your Bistro Cafe</u>	CONTACT: <u>John Doe</u>
		ADDRESS: <u>123 Main St.</u>	ADDRESS: <u>321 South St.</u>
		CITY: <u>Houston</u> , TX ZIP: <u>77065</u>	CITY: <u>Houston</u> , TX ZIP: <u>77064</u> Ph. #: <u>713-555-1212</u>